

## POV Hat 2

## POV Hat 1

## Toggle 1-6 (Standard)

## Toggle 1-6 (Switched)

Simulator/Program:  
Aircraft:

## Fire

--	--

## Fire C

--	--

## Trigger

--	--

## Second Trigger

--	--

X52 HOTAS - Document Created By Damien St Pierre  
Profile Creator:

## Mode Switch

M1	
M2	
M3	

## Fire A

--	--

## Fire B

--	--

## Pinkie Trigger

--

Recommended modifier button

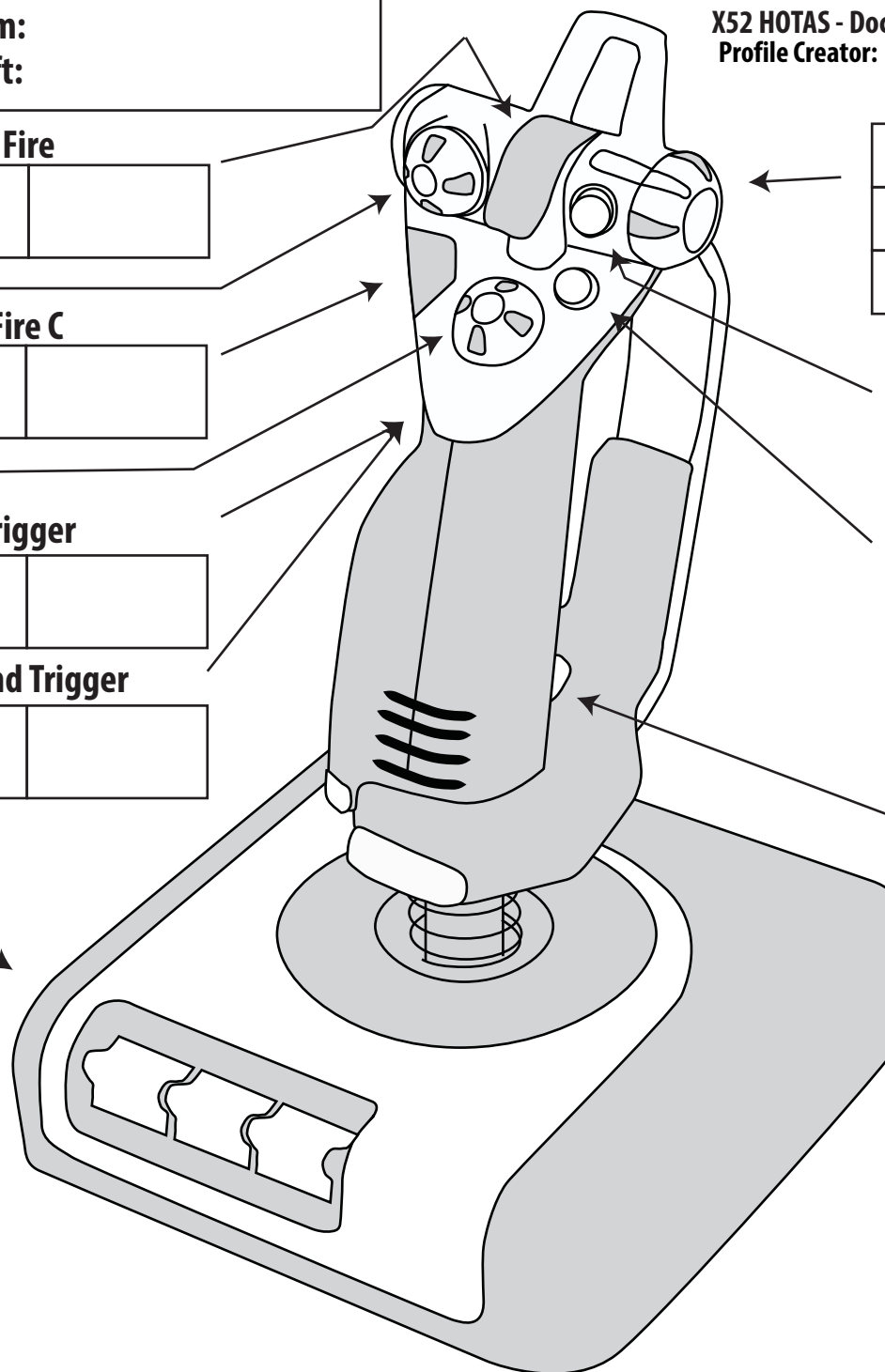

**NOTE:**  
A Button must be set to switch state/modifier for shifted functions to work.  
The Pinkie Switch is recommended for effective HOTAS operations. If the simulator doesn't have options to add modifiers set the PT to Ctrl or Shift in the Profile Editor.

## Legend

Normal Function      Shifted Function

BUTTON	MODIFIER + BUTTON
--------	-------------------

**Simulator/Program:**  
**Aircraft:**

**X52 HOTAS - Document Created By Damien St Pierre**  
**Profile Creator:**

**POV Hat 3**

**Wheel Mouse Botton 2**

Click	
Up	
Down	

**Mlni Stick**

**Throttle Base Buttons (Standard)**

--	--	--

**(Switched)**

--	--	--

**Mouse Button**

--	--

**Clutch Fixed**

--	--

*"Clutch" function must be Disabled in  
Saitek Control Panel!*

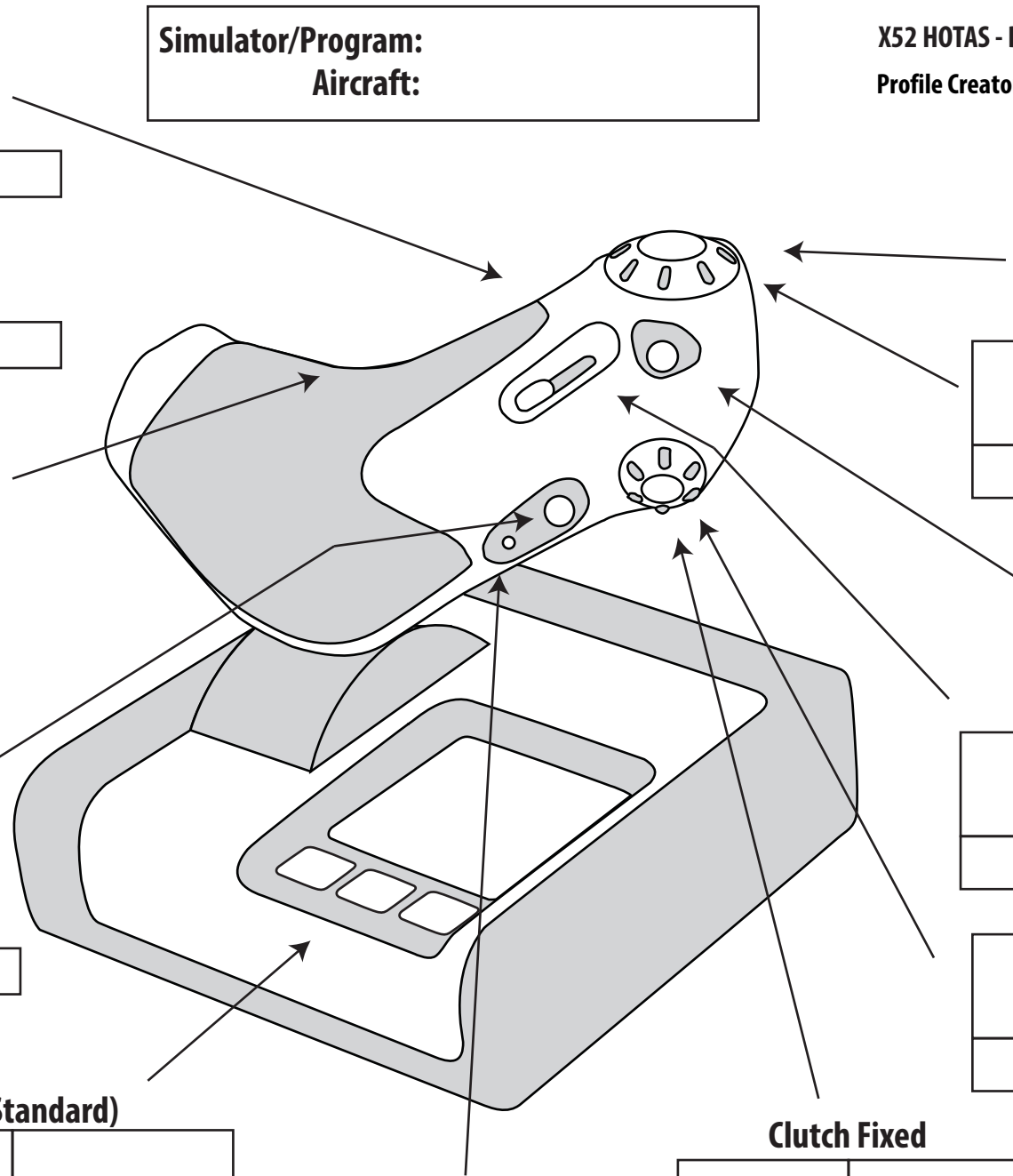

**Fire E**

--	--

**Rotary 2**

**Fire D**

--	--

**Slider**

**Rotary 1**

**NOTE:**

Slider and Rotary Wheels must be set to Bands in Saitek Profile Editor to simulate swithces or buttons.  
The Ministick may have to be set as well  
Recommended Bands are 0-20%, 20-80%, 80-100%